

THE COMMONS

THE IMPORTANT THINGS

COLLECTIVE

YOU NEED TO KNOW!

THE BIG GROUP

A CREATIVE HOSPITALITY AGENCY

THE COMMONS COLLECTIVE

A collection of historic buildings dotted on St Kilda Road stand beautiful and unassuming, passers-by oblivious to the epic celebrations happening within the many spaces that is, The Commons Collective – until now.

The Commons Collective is a complimentary contradiction; historic and chic, frivolous and formal – full of distinctive character and able to transform into whatever event you desire – hence it is not easily forgotten by those who have experienced its magic.

With history dating back to the 1890s, refurbished in the 1920s and more recently in 2017, the original Art Deco decor has been flawlessly preserved, capturing the vibe of a refined nostalgia.

The heritage listed stage and space of Ormond Hall is popular for large events of all types including spectacular shows, corporate award nights, extravagant weddings and more.

Only a stone's throw from Melbourne's CBD and walking distance from Albert Park; The Commons Collective boasts a central location sitting within the St Kilda Road Business District.

Adept at keeping all types of celebrations a world away within its central location – The Commons Collective is an experience unto itself, awaiting your unique touch to personalise the charm that is, The Commons Collective.



ORMOND HALL, EASTERN BAR & EASTERN BAR COURTYARD

Built in 1891, Ormond Hall is a heritage listed dance hall and theatre with a warm and inviting aesthetic. Originally refurbished in the 1920s, the Art Deco period finishes from this era have been retained, creating a neutral yet nostalgic space with polished timber floors, lead glass windows, ornate iron balustrades, faceted milk glass pendants and richochre stage curtains.

Ormond Hall is centrally located on St Kilda Road, within walking distance to several trams to and from the CBD. This premium and charming environment provides the perfect backdrop for a myriad of events from weddings to special birthday celebrations and corporate entertaining.

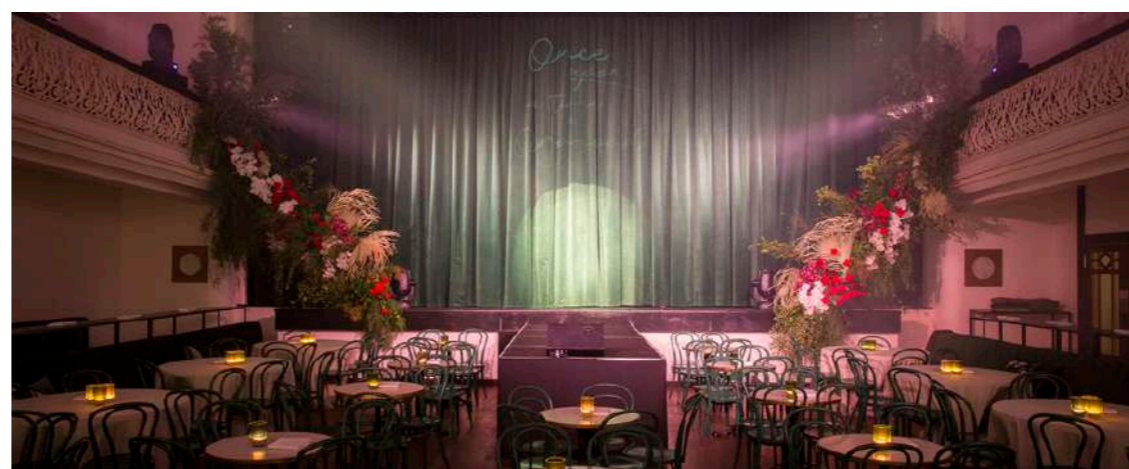

THE CHAPEL

Across the garden and around the corner, on the edge of Melbourne, sits the most graceful intimate event space, The Chapel.

High ceilings, long windows, historic charm and exposed beams, whether you're after romantic touches, a minimalist chic look or modern sophisticated with natural character, it is all possible at The Chapel. The historic walls ensure sound carries beautifully, and the intimate setting makes everyone feel involved.

A refined space with the unique ability to turn historic charm into modern-day trend.

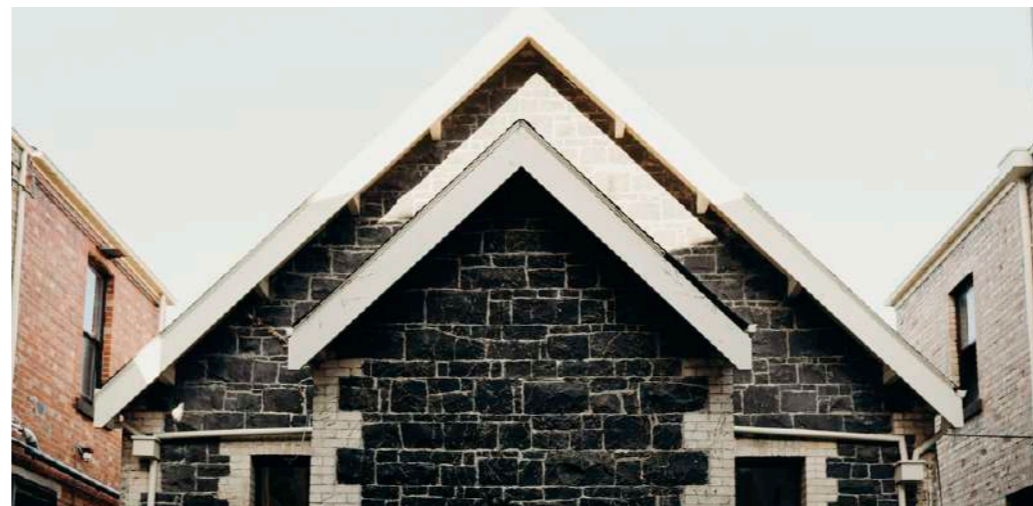
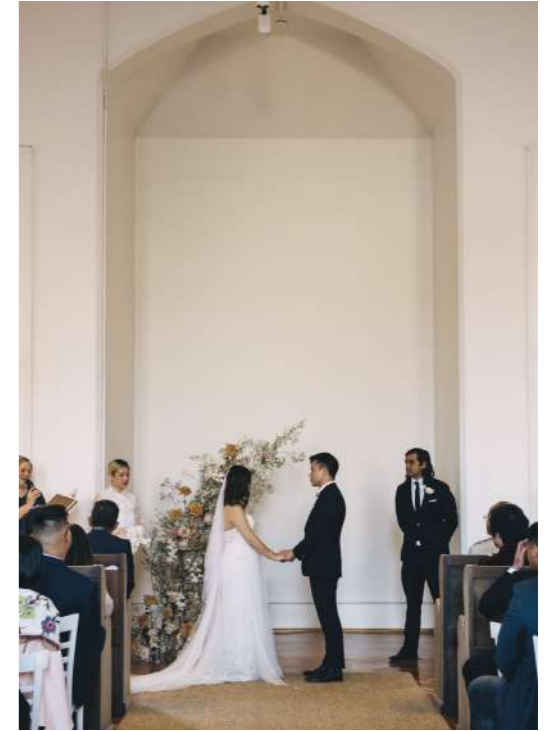

BAR MOUBRAY

Dark, sultry and oh-so-sexy, Bar Moubray is a bit of a smooth talker - it will have your full attention from the moment you arrive.

Incredibly alluring, Bar Moubray has the mystic and character typical of the prohibition era of the 1920s, with a on-trend element that makes it exemplary to the modern day.

Located within our heritage-listed bluestone building, the bar is wrapped in rich oak – panelled walls with ornate ceilings, these character finishes add distinctive refine nostalgia to the space.



THE CONSERVATORY

The Conservatory is located within the grounds, amongst leafy gardens of heritage listed trees and historic bluestone buildings. The architecturally designed Conservatory with a retractable roof, embraces the character and ambience of the heritage setting, and is a great location for cocktail parties and dinner events. The Conservatory can be layered with styling to suit any event or indulge its graceful, classic look as it is.



ROSÉ GARDEN

A series of raised garden beds, eclectic pots and trailing greenery will zone the areas into defined outdoor rooms, and guests will quickly develop a 'favourite spot' in the garden.



BEER GARDEN

The only place people will want to be on a balmy evening, The Beer Garden is the sure-fire win for groups of people wanting a cold beer after work.

The casual setting calls for guests who want a beer and a burger, or perhaps some fries and tomato sauce.

You know your guests will end up staying as the sun goes down and the overhead festoon lights flicker in the evening breeze.



ORMOND HALL, EASTERN BAR & EASTERN BAR COURTYARD

Venue Hire Breakdown

- The Hall - From \$3,500.00
- The Hall, Eastern Bar & Eastern Bar Courtyard - From \$3,500.00
- Eastern Bar & Eastern Bar Courtyard - From \$1,500.00
- The Chapel - From \$2,000.00
- The Clubhouse - From \$500.00

Venue Hire

The venue hire fee is inclusive of the following:

- 2 hour bump in prior to event start time
- 1 hour bump out on the conclusion of the event
- Security guards for the duration of the event
- Green room with a selection of furniture
- Cloaking facilities with attendant
- Round tables seating 10 guests
- Personalised menus (1 per table)
- Easel and black metal board for your guest seating allocation
- Fixed banquette seating in Eastern Bar
- 26 club and 8 high back chairs upholstered in a mix variety of green velvets, wool plaid and faux leather highlights
- Custom made table overlay cloth linen in an oatmeal colour tone and white linen napkins
- 4 sets of indoor lounge furniture with Brussels wooden coffee tables
- 8 green panelled moveable bars with brass detail to create a central bar or food stations
- Flexible green banquette seating with brass detail (available for The Hall only)
- Bentwood dining chairs in varying shades of green
- Range of crystal cut glassware and decanters
- A varied green coloured selection of Lune ridge tea light candles

Please note our venue furniture is updated seasonally. Furniture available on site will be confirmed with your Event Manager during the planning process.



BAR MOUBRAY, ROSÉ GARDEN & CONSERVATORY

Venue Hire Breakdown

- Bar Moubray - From \$2,500.00
- The Rosé Garden - From \$3,500.00
- The Conservatory - From \$2,000.00
- The Rosé Garden & The Conservatory - From \$3,500.00

Venue Hire

The venue hire fee is inclusive of the following:

- 2 hour bump in prior to event start time
- 1 hour bump out on the conclusion of the event
- Security guards for the duration of the event
- Personalised menus (1 per table)

Please note our venue furniture is updated seasonally. Furniture available on site will be confirmed with your Event Manager during the planning process.

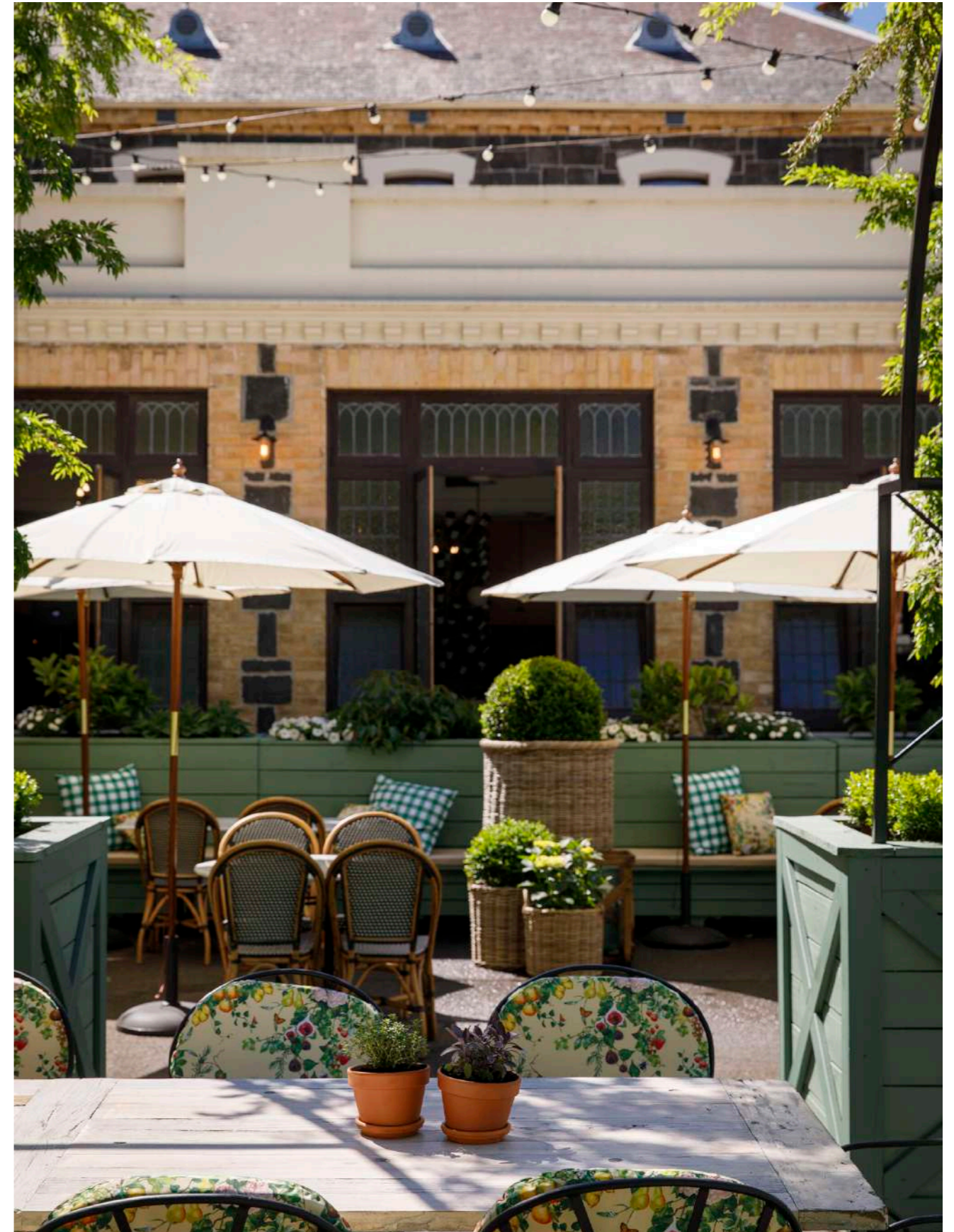

CAPACITY

ORMOND HALL, EASTERN BAR & EASTERN BAR COURTYARD

	Banquet (no dancefloor)	Banquet (with dancefloor)	Theatre	Cocktail	Cabaret
Ormond Hall	200	180	300	300	160
Eastern Bar & Eastern Bar Courtyard	48	-	-	100	-
The Chapel	80	60	110	120	64

BAR MOUBRAY, ROSE GARDEN, THE CONSERVATORY & BEER GARDEN

Bar Moubray	100	-	-	250	-
Rosé Garden	244	-	-	480	-
The Conservatory	80	-	-	100	-
Beer Garden*	208	-	-	208	-

*Based on the Beer Garden furniture

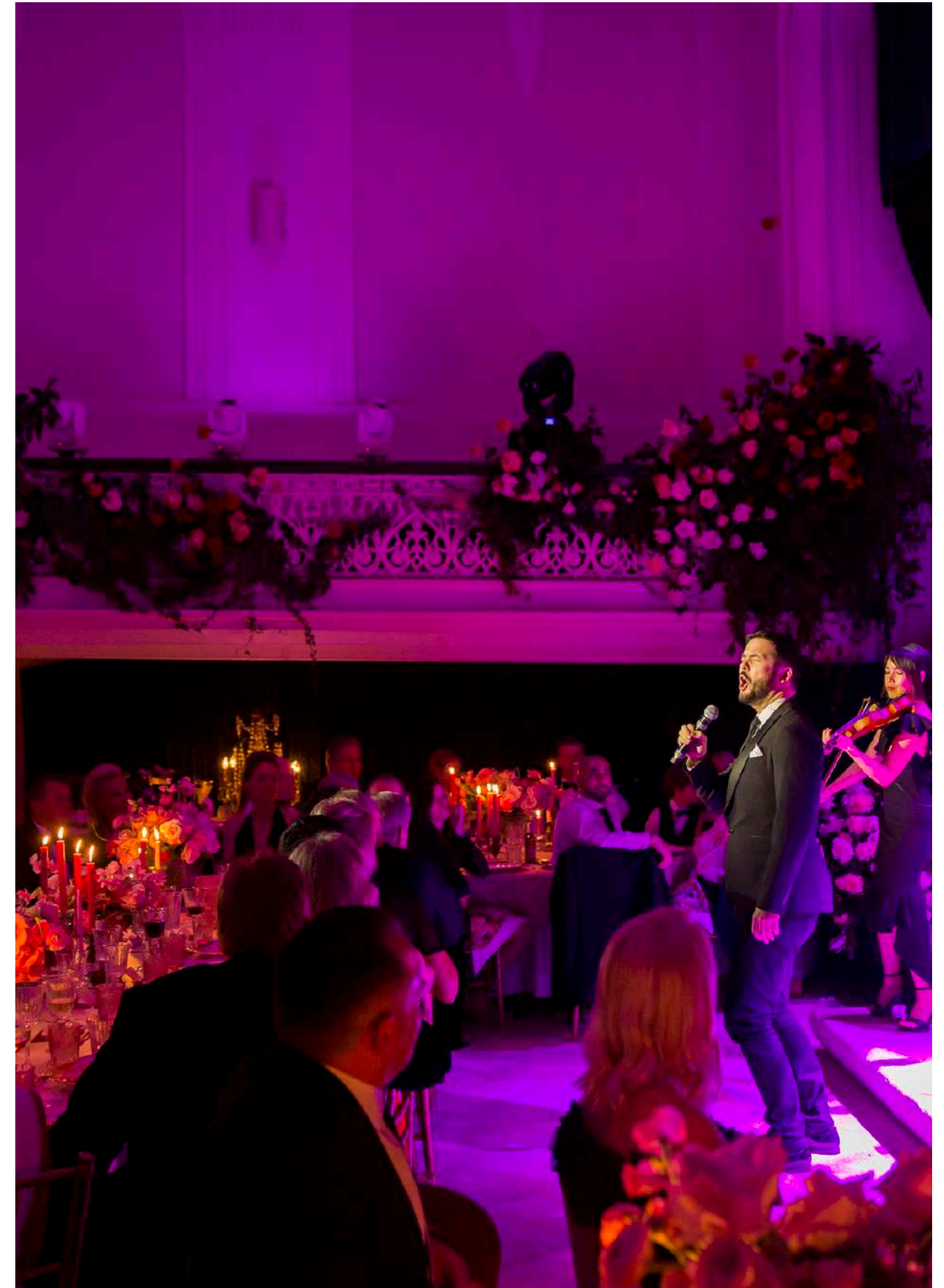

THE EXTRAS

Audio Visual Supplier

Harry the Hirer are our preferred in-house audio visual supplier at Ormond Collective delivering superior audio visual services, technology and coordination solutions to our client's for their events.

All events held in Ormond Collective are required to use the in-house PA System for speeches, presentations and entertainment, as it has automated noise control systems built in.

Ormond Collective On-Site Equipment

The following equipment is provided on a complimentary basis;

The Hall Equipment

- A clear acrylic lectern
- Lectern microphones
- Nexo Geo S Line Array system with subs woofers
- Fold-back speaker rig of 4 wedges for bands
(require audio operator to set and tune)

An audio visual technician will be required during your event to manage the in house equipment. Technician charges are from \$85.00 per hour, with a minimum 4-hour booking.

We encourage you to speak directly with an experienced member of HTH productions regarding options for audio visual or lighting solutions to enhance your event. Please feel welcome to contact Emma Rogers on 03 9425 8666 or emmar@harrythehirer.com.au

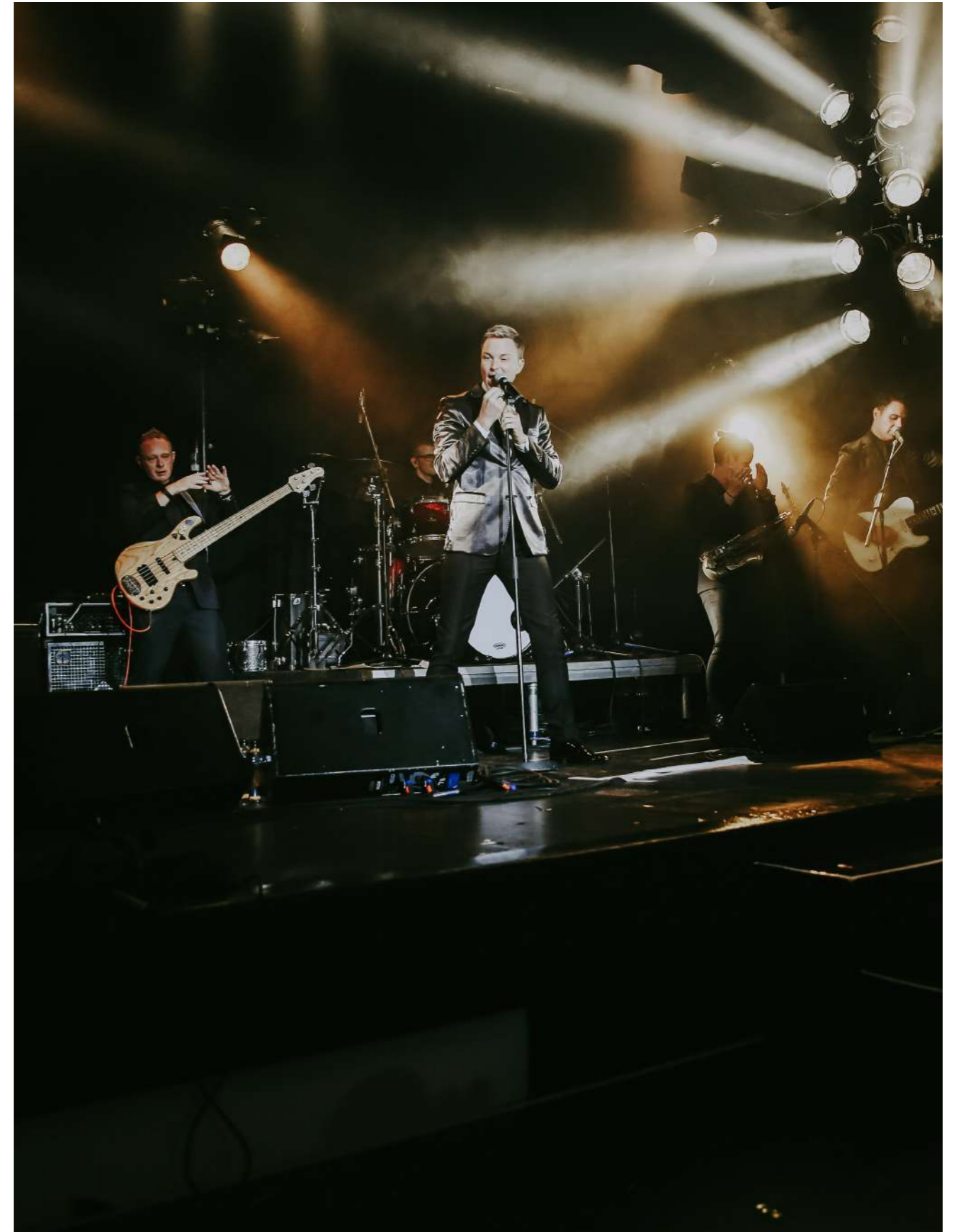

MORE EXTRAS...

Noise Restrictions

Due to residential zoning, acoustic/non-amplified entertainment is allowed in the courtyard area until 10pm. After this time any extended entertainment will need to be held in the Ormond Hall or Bar areas.

Amplified entertainment is not available in The Courtyard or Pavilion areas.

Liquor License Guidelines

Ormond Collective holds an on-premises catering liquor licence until 1am Monday – Saturday, and 11pm on Sundays. The Commons licence is until 10pm.

For further questions in relation to liquor licencing please see your Event Manager.

COVID Safe Practices

The Big Group adheres to all government directives regarding hosting events within a COVID safe environment. The Big Group does provide COVID QR Code check in upon guest arrival and hand sanitation stations placed around throughout the venue. The Big Group COVID safe plan can be supplied if required.

Parking

Ticketed parking is available for guests attending the event along Moubray Street and St Kilda Road.



FLOORPLAN

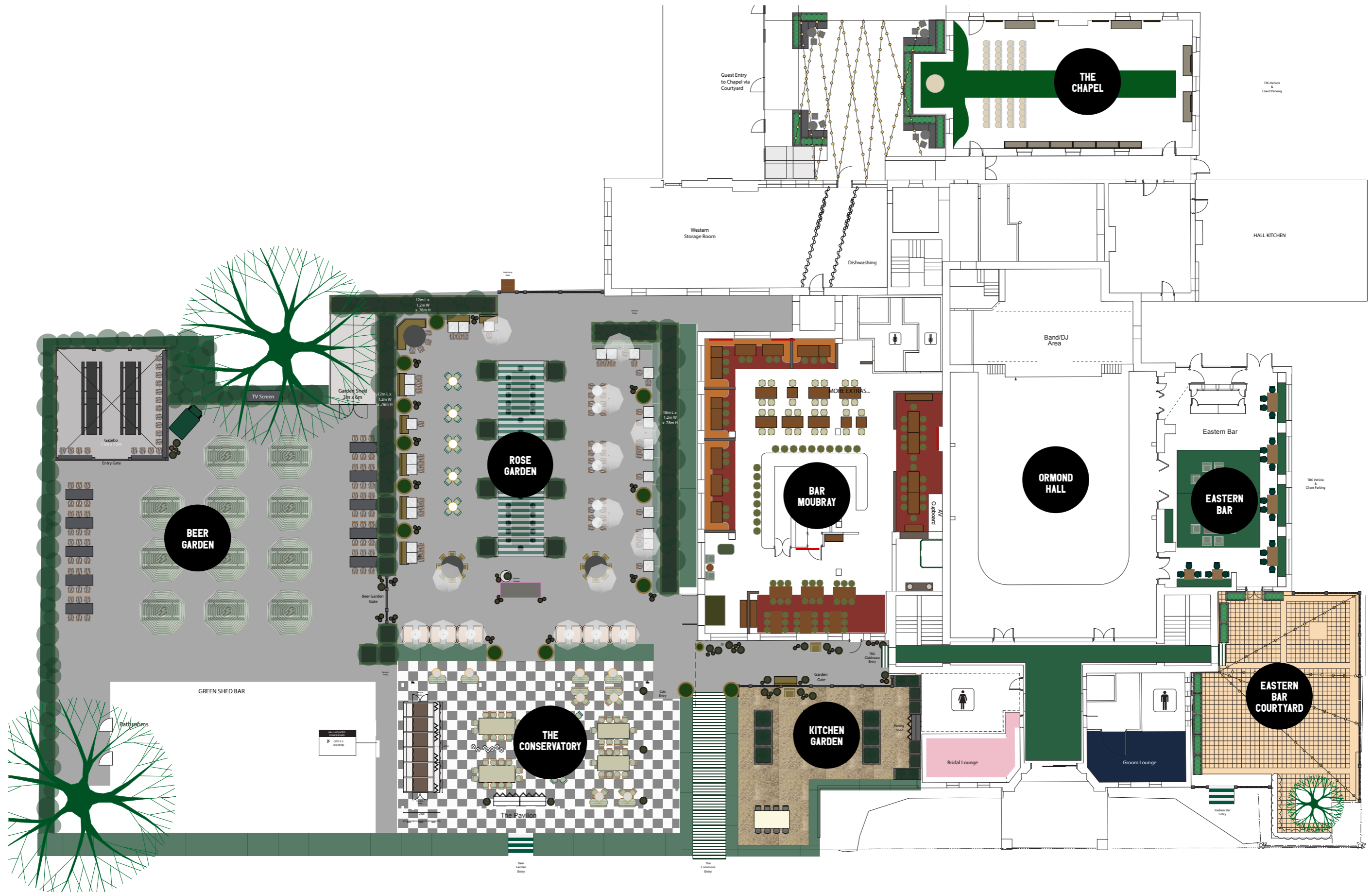



CONTACT US

T. (03) 8416 9700

EMAIL US

CONCIERGE(AT)THEBIGGROUP.COM.AU

THE BIG GROUP

CREATIVE

HERE'S TO AN UNFORGETTABLE PARTY

(THAT WE HOPE YOU'LL REMEMBER
TOMORROW...)

THE BIG GROUP
CREATIVE